

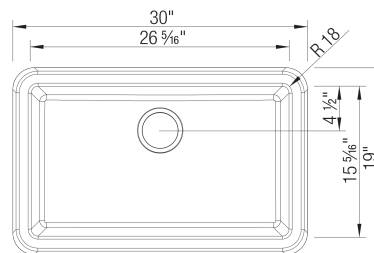

## Sink Specifications

Colour	SKU
Anthracite	401831
Café	401832
White	401833
Cinder	401858
Metallic Grey	401865
Truffle	401866
Coal Black	402643

## IKON 30 SILGRANIT



### Design and planning tips

- Min cabinet size: 33 in ( 840 mm )
- Sink Bowl 1 Length (left-to-right): 26,31 in ( 668.0 mm )
- Sink Bowl 1 Width (front-to-back): 15,31 in ( 389.0 mm )
- Bowl Depth: 9,25 in ( 235.0 mm )
- Apron front height: 10 in ( 254 mm )
- Rim thickness: 1.5 in ( 38 mm )

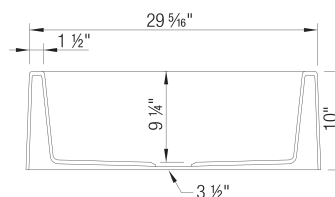

### Specifications:

3 1/2" (90 mm) stainless steel strainer(s)

Installation instructions

Cabinet template

Limited Lifetime Warranty

Custom cabinet installation required.

Must ship on a pallet.

Cubed weight: 136 lbs.

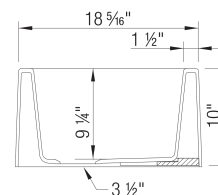

### Optional Accessories

Floating Grid	406533
Sink Grid	406534
CapFlow Strainer Cover	517666
Beech Cutting Board	235010

### Warranty

Limited lifetime warranty on all sinks and faucets. One-year warranty on all accessories and soap dispensers.

### Code/Standards Compliance

BLANCO sinks and faucets are third-party tested and certified to CSA, cUPC, ANSI/ASME, IAPMO and NSF standards and listed by applicable certification bodies. For more information on individual product listings, contact our office or listing organization.



Need support? Learn more by watching our sink & faucet How-to videos:

<https://www.blanco.com/ca-en/support/how-to-videos/how-to-videos-for-sinks/>



BLANCO Canada Inc  
100 Corporation Drive  
Brampton ON L6S 6B5

### Tel & Fax

Tel: 905-494-2400 Toll free: 1-877-425-2626

Fax: 905-494-2425 Toll free: 1-877-825-2626

While BLANCO strives to provide accurate information, all images and dimensions in this document are intended for reference only and are subject to change at any time without notice. This document is not intended for use as an installation guide. For

---

technical installation details, refer to installation instructions provided with the product. BLANCO assumes no responsibility for the use of superseded or voided specifications.